



P2x Indoor LED



Specifications

LED Type	SMD 2121
Cabinet Size(WXHXDmm)	500x500x98 mm
Cabinet Resolution	168x168 pixel
Module Quantity pcs/cabinet	4
Module Pixels	7056 pixels
Cabinet Pixels	28.224 pixels
Average Power Consumption	100 watt
Max. Power Consumption	137 watt
Material Die-Cast	Die Cast Magnesium Alloy
Cabinet Weight	7.65kg
Transparent	No
Flybar	50cm
Brightness	≥1000 nit
Colors	68 Billion
Driving Method	1/16
View Angle	Horizontal 140°, Vertical 100°
Min. Viewing Distance	2 meters
Brightness Control	Red,Green,Blue 256 Grade/Each
Fresh frequency	≥1920Hz
Frame Frequency	50 - 60Hz
Input Voltage	200~240 (or100~120)
Defects Rate	≤0.00001
Max Vertical Hanging	20 cabinets
Life span	≥100,000 hours
Module Brightness Uniformity	<3%
Gray Scale	65536
Earth Leakage Current	<3mA
Ingress Protection (front / rear)	IP40/IP21
Controlling system	HD-MPVP2 (DVI,HD-SDI, HDMI, Etc)

Safety warnings

1. Please don't install this LED Screen in intense magnetic and high-voltage fields.
2. To reduce the risk of component damage and fire caused by short circuit, make sure correct connection
3. Check if the voltage and power input suit the LED requirement
4. Don't connect cables with power on, make sure a correct connection and no short circuit checked with instrument before power on.
5. Please don't open Receiver cover while still LED still on to avoid risk.

Dimensions

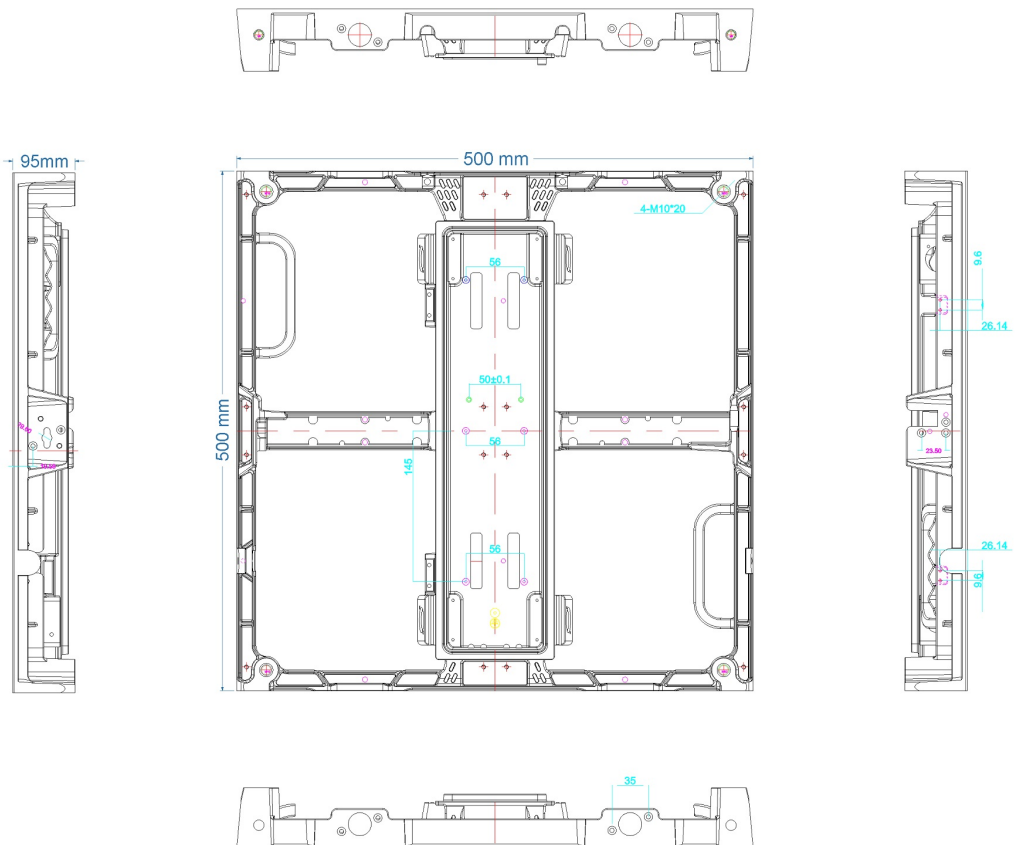

Curve Feature :

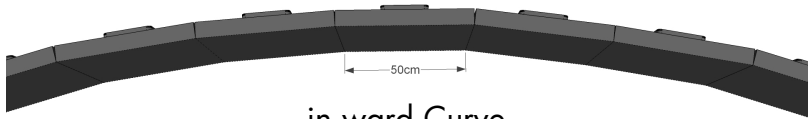

in-ward Curve

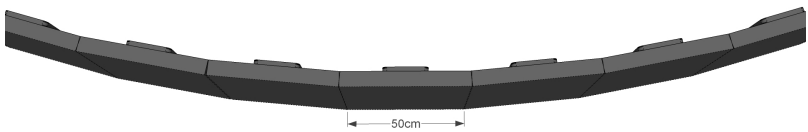

out-ward Curve

-
- Supports both concave (in-ward) and convex (out-ward) design
 - Three-angle adjustment locking system :
Flat (0 °), concave (+5°), convex (-5 °) curve installation
-

